

ASSEMBLY INSTRUCTIONS FOR TRANSPORT CART DOOR & LOCK ACCESSORY KIT

Tools Requirements: Phillips Screwdriver, Rubber Mallet; cushioned assembly surface

Parts:

Left-hand Door, Right-hand Door, Lock, Keys (lock parts listed below)
(Doors are identified on their interior sides, along with markings indicating which side faces up)

First install the back Shelf Panels as instructed on the Panel Assembly Instruction Sheet.

To install the Doors and Lock, first familiarize yourself with all components. Locate the two matched sets of sockets (top front edge of Bottom Shelf and lower front edge of Middle Shelf). Install the Lock on the Right-hand Door before attaching Doors to Cart.



CC2036DP

Lock:

Lock Parts:

Innermost bag includes:

These parts below will be used for lock assembly along with 4 additional parts from the outermost bag:



Keys



Lock



3/4" Nut



90° Stop Washer

*The parts shown below are **not needed** for lock assembly and can be discarded:*



Trim Ring



Spur Washer
(for wood)



Straight
Cam



Offset
Cam



Screw w/
Lock Washer

180° Stop
Washer

Lock Parts:

Use the following parts from the outermost bag:

Clear Lock
Thread Protector



Offset
Toggle



Lock
Washer



Philip's Head
Screw



See reverse side for installation of Lock and Door Panels.

P.O. Box 53006
Oklahoma City, Oklahoma 73152-3006
(405) 475-5600 • FAX (405) 475-5607
1-800-654-8210
www.carlislefsp.com

European Distribution Center:
Edisonstraat 84, P.O. Box 110
6900 AC Zevenaar, The Netherlands
Tel +31/(0)316-596550 • Telex 45642
FAX +31/(0)316-340168
#104803327

CARLISLE
FoodService Products

Lock Assembly:

1) Insert the Lock through the opening in the door as shown with the notch on the bottom side, as indicated. Secure the Lock with the 3/4" Nut, slide the Clear Lock Thread Protector over the threaded end of the Lock, making sure to push it on completely so that it is flush with the 3/4" Nut as much as possible. Orient the 90° Stop Washer as shown and slide it on the square portion at the end of the Lock. Orient the Offset Toggle, also as shown, and slide it over the square portion at the end of the Lock. Secure these with the Lock Washer and Philip's Head Screw using a Philip's head screwdriver. . Using one of the keys, the assembled lock should function as shown in the graphic below.

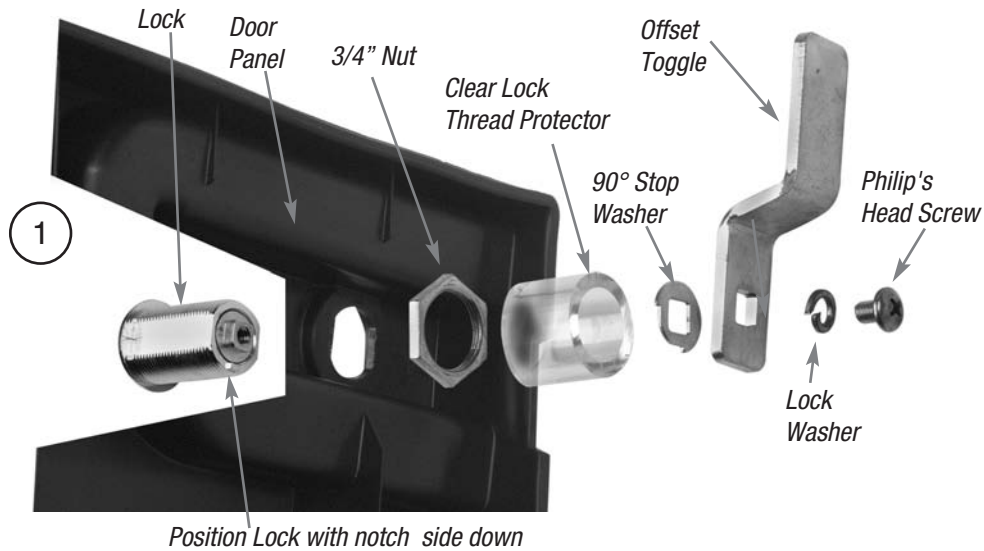

Door – Unlocked Position



Door – Locked Position

Door Assembly:



1d) After inserting both Panels, locate the two large sockets on the front edge of the underside of the Middle Panel

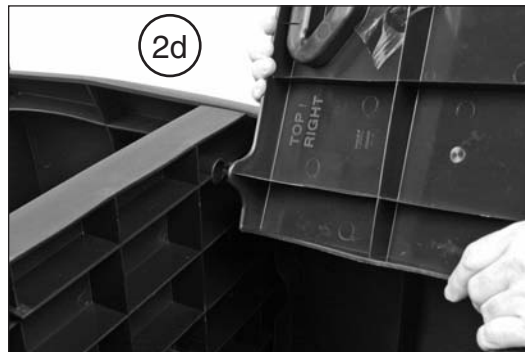

2d) Starting with the Right-Hand Door properly oriented (right side as looking at the Cart), insert the large peg on the top of the Door into the right socket under the Middle Shelf.



3d) Applying firm steady pressure, slide the Door towards the corner of the Cart until the peg at the bottom snaps into the right socket located on the top front edge of the Bottom Shelf. You may use the Rubber Mallet

to help slightly loosen the Middle Shelf on the edge immediately above the Door if the fit is too tight. Remember to knock the shelf back in place if you do this. When properly installed, the Door should swing freely when opening or closing.



4d) Repeat steps #2 and #3 with the Left-Hand Door